



## SKL / SKL LS

Screw compressor, gear box version.

**CVS develops and manufactures compressors specifically designed for installation in trucks. The development is made in close collaboration with our customers. This guarantees the optimum product for your application.**



### The oil free screw compressor

The oil free screw compressor SKL with gear box was developed specifically for the bulk tanker industry.

### Features

- » High standard of build quality.
- » Unique and robust design guarantee long lasting performance and high operating hours.
- » Compact and light-weight design for increased payloads.

### Screw compressors with system

The volume flow rate of the SKL with gear box ranges from 385 up to 1050 m<sup>3</sup>/h at different input drive speeds (please view technical data). The newly developed design of screw ensures increased efficiency and low discharge air temperatures with low noise operation.



### Advantages

- » Option of two gearbox ratios: 1:2 and 1:2.5
- » Clockwise or counter-clockwise rotation.
- » Wide drive speed range.
- » Input drive shaft can be mounting in vertical or horizontal orientations.



Dimensions

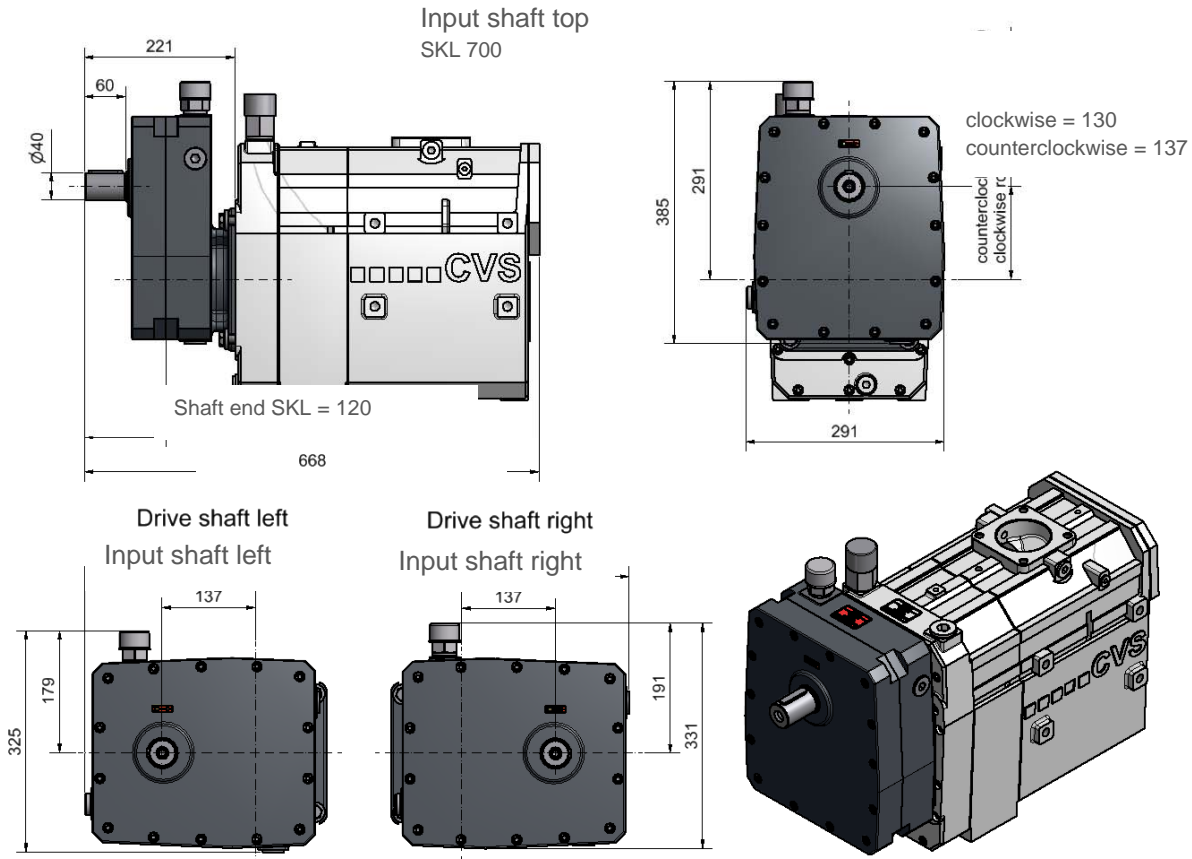

Ratio	Rotation direction	Valid location of the shaft		
		top	right	left
2.0	(cw) clockwise	top	right	---
2.0	(ccw) counterclockwise	top	right	left
2.5	(ccw) counterclockwise	top	right	left

Technical data

		SKL 700 / SKL 700 LS		SKL 1100 / SKL 1100 LS	
Volume flow at free air	m <sup>3</sup> /h	420	650	550	1050
Volume flow at 2 bar g	m <sup>3</sup> /h	385	600	490	980
Max. pressure	bar	2.5	2.5	2.5	2.5
Speed range: with gear box 1:2	1/min	1200 – 1800 / 975 – 1465		1000 – 1800 / 815 – 1465	
with gear box 1:2,5		960 – 1440 / 780 – 1172		800 – 1440 / 652 – 1172	
Power requirement at 2 bar g	kW	22.5	33.5	29.0	52.5
Weight	kg	152 / 159		165 / 172	

Technical information subject to change